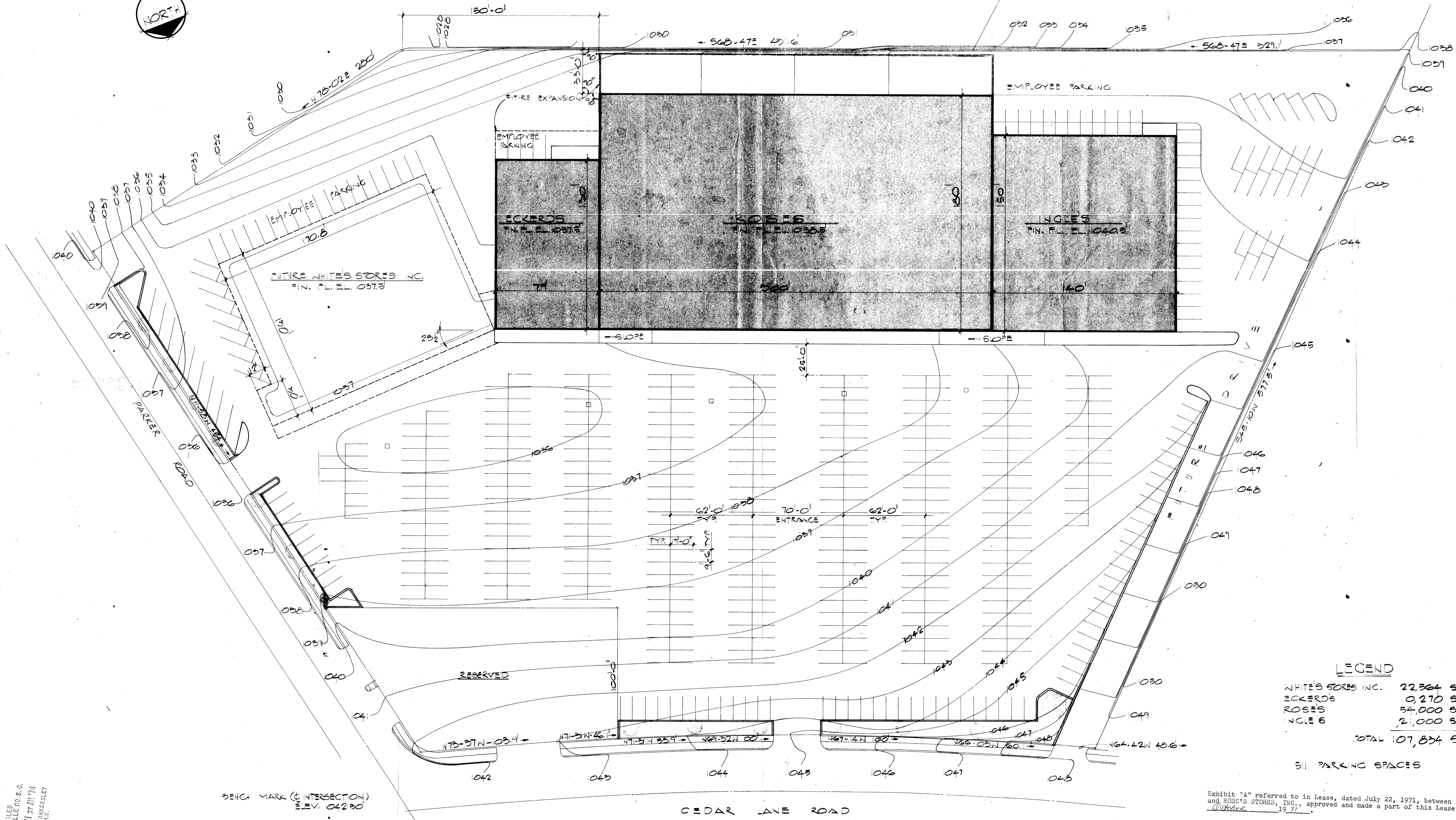

EXHIBIT "A"

AVAILABLE FOR FUTURE EXPANSION



**LEGEND**

WHITE'S STORES INC.	22,364 SQ. FT.
ECKERD'S	0,270 SQ. FT.
ROSES	54,000 SQ. FT.
INGLES	21,000 SQ. FT.
<b>TOTAL</b>	<b>107,634 SQ. FT.</b>

511 PARKING SPACES

Exhibit "A" referred to in Lease, dated July 22, 1971, between FURMAN REALTY CO., INC. and ROSS'S STORES, INC., approved and made a part of this Lease this 19th day of August, 1974.

FURMAN REALTY CO., INC.  
By: *James P. ...*  
President

ROSS'S STORES, INC.  
By: *[Signature]*  
President

FILED  
GREENVILLE CO. S. C.  
AUG 19 11 37 AM '74  
DUNN & STANLEY  
R.A.C. GREENVILLE

BENCH MARK (INTERSECTION)  
BY 04280

4R-93

AUG 19 1974

4R-94

AUG 19 1974

4779

4779

SHOPPING CENTER FOR THE FURMAN CO. GREENVILLE, SOUTH CAROLINA	DATE JULY 22, 71	LILES, CLARKE and ASSOCIATES architects and engineers GREENVILLE, SOUTH CAROLINA AND ATLANTA, GEORGIA	JOB NO. 7 80
	DRAWN L.H.J.		DWG NO. A
	CHECKED		SHEET OF